

1 : 100

Scale: 1 : 100	Issue: 1
Page: 4 of 14	
Date: 12/04/2025	
Drawing No: 2454	

**EAVE VENTILATION OPENINGS TO BE
INSTALLED IN ACCORDANCE WITH PART
10.8.3 - VENTILATION OF ROOF SPACES
NCC - BCA 2022 (VOLUME 2) HOUSING
PROVISIONS STANDARD.**

<u>Window Schedule</u>				
Mark	Height	Width	Type Comments	Area
S1	1180	550	Selected Skylight	0.65 m ²
S2	700	550	Selected Skylight	0.39 m ²
W1	1460	2170	Sliding Window	3.17 m ²
W2	1460	2170	Sliding Window	3.17 m ²
W3	2410	5300	Stacker Door	12.77 m ²
W4	1030	850	Awning Window - Obscured Glass	0.88 m ²
W5	1030	850	Awning Window	0.88 m ²
W6	1460	850	Fixed Window - Obscured Glass	1.24 m ²
W7	1460	2650	Sliding Window	3.87 m ²

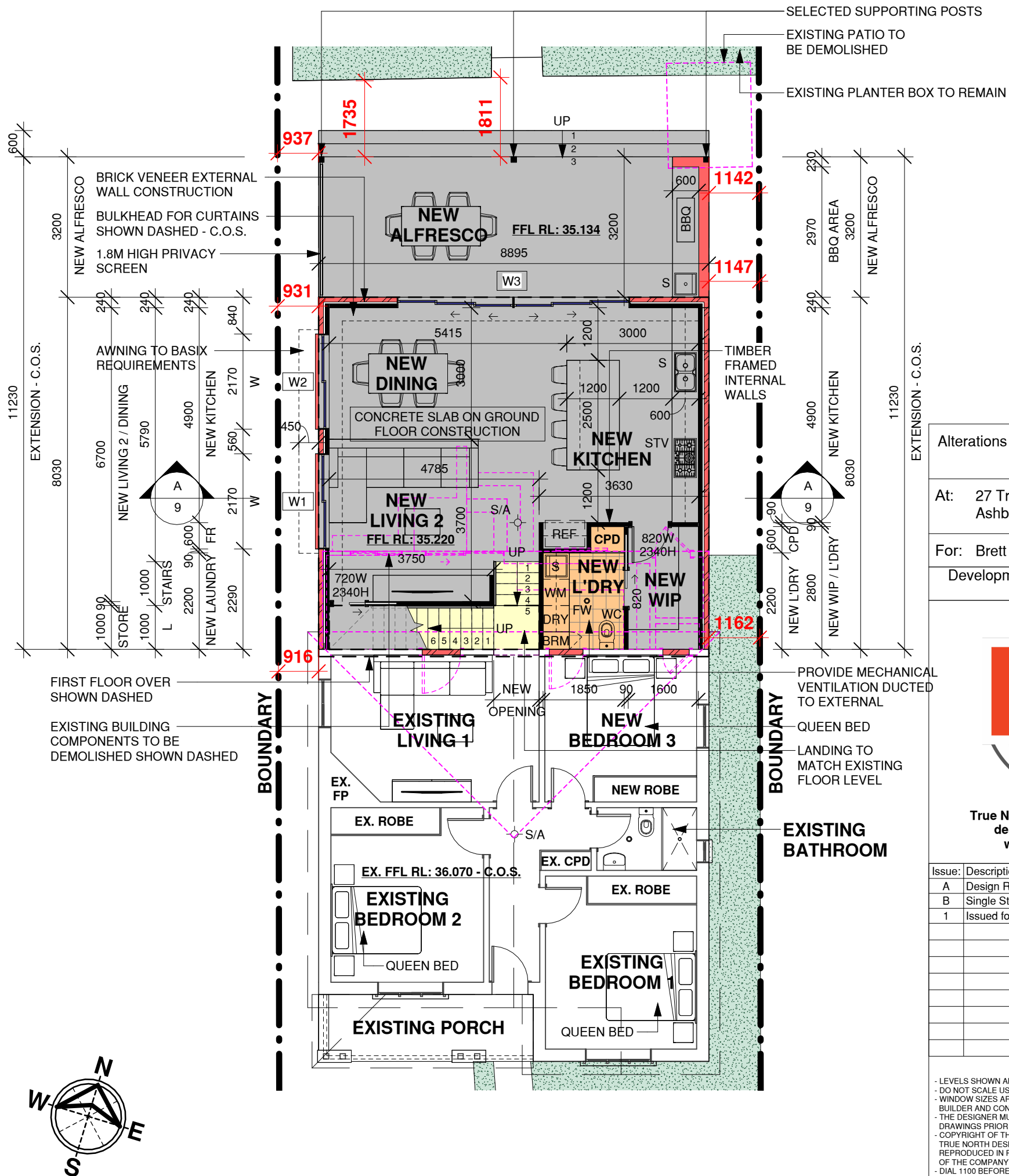

Existing & Proposed Ground Floor Plan

1 : 100

-ALL WINDOWS TO BE CONFIRMED BY BUILDER AND OWNER PRIOR TO ORDERING.
-WINDOW SIZES ARE INDICATIVE ONLY, FINAL SIZES PROVIDED BY BUILDER AND CONFIRMED ON SITE.
-WINDOWS TO COMPLY WITH RELEVANT BASIX REQUIREMENTS ACCORDING TO ACCOMPANYING BASIX CERTIFICATE.
-ALL WINDOWS MUST BE INSTALLED IN ACCORDANCE WITH **CLAUSE 11.3.7 (PROTECTION OF OPENABLE WINDOWS - BEDROOMS) & CLAUSE 11.3.8 (PROTECTION OF OPENABLE WINDOWS - ROOMS OTHER THAN BEDROOMS)** IN ACCORDANCE WITH THE **NATIONAL CONSTRUCTION CODE - BUILDING CODE OF AUSTRALIA 2022 (HOUSING PROVISIONS STANDARD)**

Alterations & Additions

At: 27 Trevenar Street,
Ashbury

For: Brett Guerin & Monika Drankowska
Development Application & Construction Certificate



True North Design & Drafting Pty Ltd
design@truenorthdd.com.au
www.truenorthdd.com.au

[illegible]

- LEVELS SHOWN ARE APPROX ONLY AND SHOULD BE VERIFIED ON SITE
- DIMENSIONS ARE APPROXIMATE WHERE AVAILABLE
- WINDOW SIZES ARE INDICATIVE ONLY FINAL SIZES PROVIDED BY BUILDER AND CONFIRMED ON SITE.
- THE DESIGNER MUST BE NOTIFIED OF ANY DISCREPANCIES ON THE DRAWINGS PRIOR TO ANY CONSTRUCTION WORKS.
- COPYRIGHT OF THIS DRAWING AND/OR DESIGN IS THE PROPERTY OF TRUE NORTH DESIGN & DRAFTING PTY LTD AND SHOULD NOT BE REPRODUCED IN PART OR WHOLE WITHOUT THE WRITTEN PERMISSION OF THE COMPANY.
- DIAL 1100 BEFORE YOU DIG PRIOR TO ANY EARTH EXCAVATION.

COPYRIGHT ©2024 BY TRUE NORTH DESIGN & DRAFTING PTY LTD. ALL RIGHTS RESERVED.

Scale: 1 : 100

Page: 5 of 14

Date: 12/04/2025

Drawing No:
2454

1

⊕ S/A
DENOTES SMOKE ALARM
SMOKE ALARMS TO BE HARDWIRED AND INTERCONNECTED IN ACCORDANCE WITH AS3786-2014 AND PART 9.5 OF THE NCC - BCA 2022 (HOUSING PROVISIONS STANDARD)

EAVE VENTILATION OPENINGS TO BE INSTALLED IN ACCORDANCE WITH PART 10.8.3 - VENTILATION OF ROOF SPACES NCC - BCA 2022 (VOLUME 2) HOUSING PROVISIONS STANDARD.

Window Schedule				
Mark	Height	Width	Type Comments	Area
S1	1180	550	Selected Skylight	0.65 m ²
S2	700	550	Selected Skylight	0.39 m ²
W1	1460	2170	Sliding Window	3.17 m ²
W2	1460	2170	Sliding Window	3.17 m ²
W3	2410	5300	Stacker Door	12.77 m ²
W4	1030	850	Awning Window - Obscured Glass	0.88 m ²
W5	1030	850	Awning Window	0.88 m ²
W6	1460	850	Fixed Window - Obscured Glass	1.24 m ²
W7	1460	2650	Sliding Window	3.87 m ²

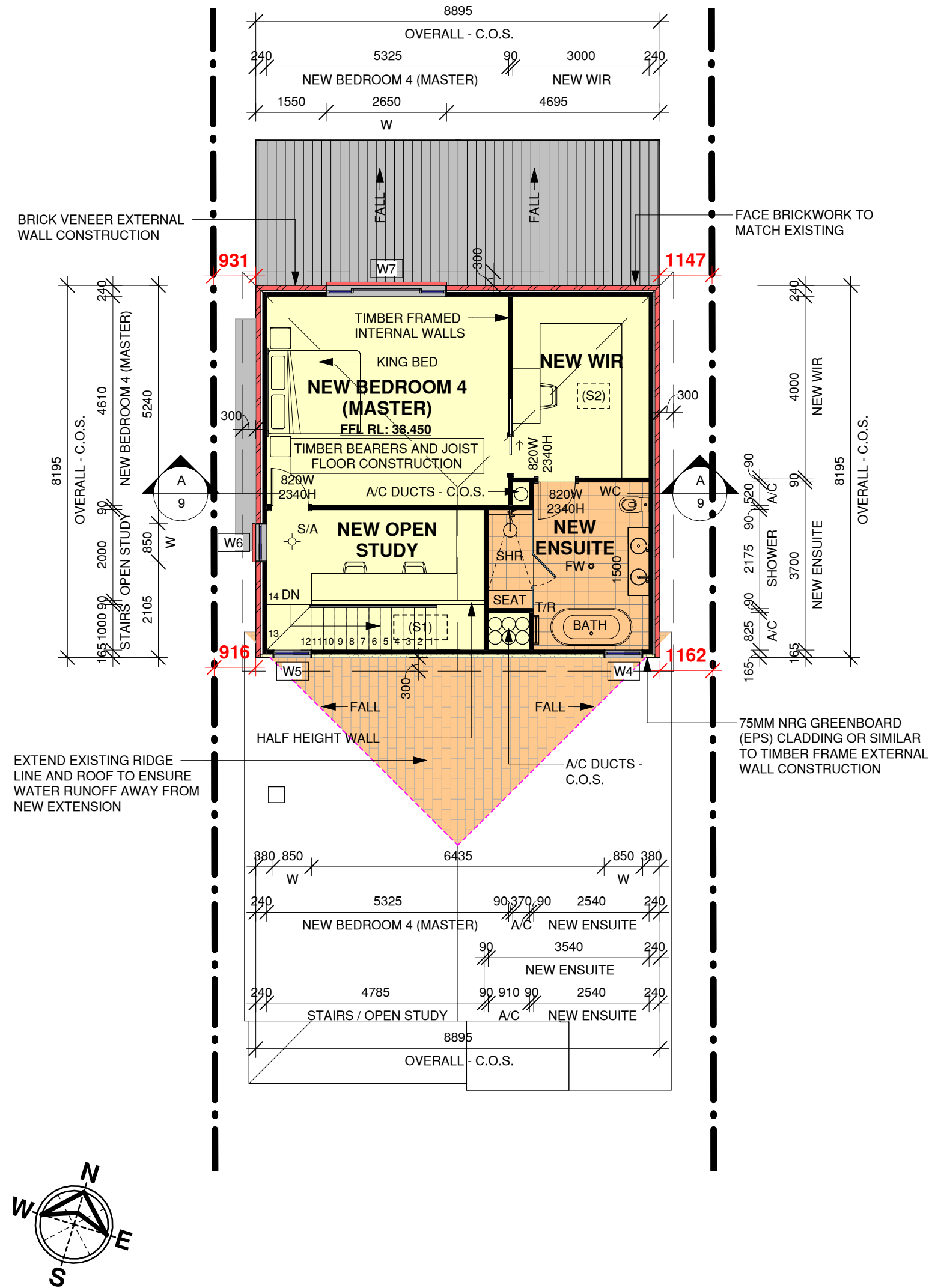

Alterations & Additions

At: 27 Trevenar Street, Ashbury

For: Brett Guerin & Monika Drankowska

Development Application & Construction Certificate



True North Design & Drafting Pty Ltd
design@truenorthdd.com.au
www.truenorthdd.com.au

Issue:	Description:	By:	Date:
A	Design Review - Draft 3	D.K.	21/03/2025
B	Single Storey Option	D.K.	07/02/2025
1	Issued for DA Submission	D.K.	12/04/2025

- LEVELS SHOWN ARE APPROX. ONLY AND SHOULD BE VERIFIED ON SITE
- DO NOT SCALE USE DIMENSIONS WHERE AVAILABLE.
- WINDOW SIZES ARE INDICATIVE ONLY FINAL SIZES PROVIDED BY BUILDER AND CONFIRMED ON SITE.
- THE DESIGNER MUST BE NOTIFIED OF ANY DISCREPANCIES ON THE DRAWINGS PRIOR TO ANY CONSTRUCTION WORKS.
- COPYRIGHT OF THIS DRAWING AND/OR DESIGN IS THE PROPERTY OF TRUE NORTH DESIGN & DRAFTING PTY LTD AND SHOULD NOT BE REPRODUCED IN PART OR WHOLE WITHOUT THE WRITTEN PERMISSION OF THE COMPANY.
- DIAL 1100 BEFORE YOU DIG PRIOR TO ANY EARTH EXCAVATION.

COPYRIGHT ©2024 BY TRUE NORTH DESIGN & DRAFTING PTY LTD. ALL RIGHTS RESERVED.

Scale: 1 : 100	Issue: 1
Page: 6 of 14	
Date: 12/04/2025	
Drawing No: 2454	

Proposed First Floor Plan

1 : 100

ADDITIONAL NOTES:

- ALL WINDOWS TO BE CONFIRMED BY BUILDER AND OWNER PRIOR TO ORDERING.
- WINDOW SIZES ARE INDICATIVE ONLY, FINAL SIZES PROVIDED BY BUILDER AND CONFIRMED ON SITE.
- WINDOWS TO COMPLY WITH RELEVANT BASIX REQUIREMENTS ACCORDING TO ACCOMPANYING BASIX CERTIFICATE.
- ALL WINDOWS MUST BE INSTALLED IN ACCORDANCE WITH **CLAUSE 11.3.7 (PROTECTION OF OPENABLE WINDOWS - BEDROOMS) & CLAUSE 11.3.8 (PROTECTION OF OPENABLE WINDOWS - ROOMS OTHER THAN BEDROOMS) IN ACCORDANCE WITH THE NATIONAL CONSTRUCTION CODE - BUILDING CODE OF AUSTRALIA 2022 (HOUSING PROVISIONS STANDARD)**